

5/32 Hex Male-Female Standoff

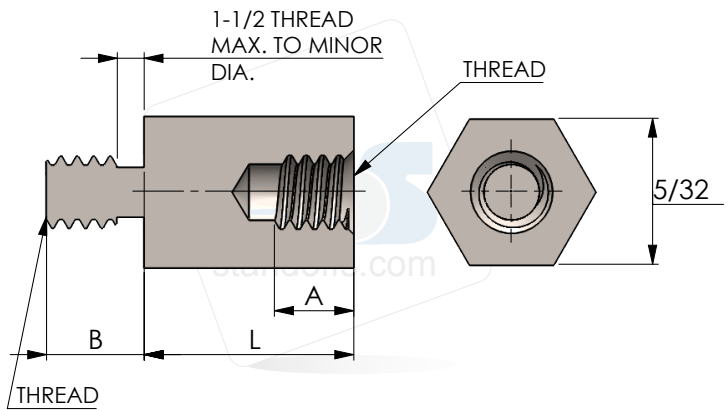

Hex Length Table		
✓ FCXXXX	Length (L)	
FC4450	3/16	
FC4451	1/4	
FC4452	5/16	
FC4453	3/8	
FC4454	7/16	
FC4455	1/2	
FC4456	9/16	
FC4457	5/8	
FC4458	11/16	
FC4459	3/4	
FC4460	13/16	
FC4461	7/8	
FC4462	15/16	
FC4463	1	
FC4464	1-1/16	
FC4465	1-1/8	
FC4466	1-3/16	
FC4467	1-1/4	
FC4468	1-5/16	
FC4469	1-3/8	
FC4470	1-7/16	
FC4471	1-1/2	
FC4472	1-9/16	
FC4473	1-5/8	
FC4474	1-11/16	
FC4475	1-3/4	
FC4476	1-13/16	
FC4477	1-7/8	
FC4478	1-15/16	
FC4479	2	

Create a part number:

Length	Thread	Material	Finish
FCXXXX	XXX	XX	XX
_____ - _____ - _____ - _____			

Thread			
Short lengths, 'A' tapped to maximum depth			
✓	Thread Code (XXX)	Depth (A)	Length (B)
	256	3/16	5/32
	440	1/4	3/16

Material		
✓ Material Code (XX)		
A	Aluminum	
B	Brass	
S	Steel	
SS	Stainless Steel	
N	Nylon	

Tolerances
Unless otherwise Specified
 .xxx +/- .005
 .xx +/- .010
 Angular +/- 1 Degree
 Linear +/- .005
Break all sharp edges

✓ Compatible Finish		
A, B, S, SS	0 - Plain	
B, S	5 - Nickel Plate (QQ-N-290)	
A	6 - Iridite #14 Gold (MIL-C-5541E)	
A	7 - Iridite Clear (MIL-C-5541E)	
A	9 - Alodine 1200	
B, S	12 - Zinc Clear (ASTM-B-633)	
B, S	16 - Electro Tin (MIL-T-10727 TYPE 1)	
SS	20 - Passivation (MIL-F-14072D)	
A	22 - Clear Anodize (MIL-A-8625-TYPE2) (Sulphuric) Hot Water Seal (Clear)	
A	24 - Black Anodize (MIL-A-8625)	
B, S, SS	26 - Black Oxide	
B, S	28 - Zinc Yellow (ASTM-B-633)	



5046 W Linebaugh Ave
 Tampa, FL, 33624
 sales@mbs-standoffs.com
 Mbs-Standoffs.com
 P: (813) 938-6025
 F: (813) 425-9007

Source Control Drawing:
 To be produced by
 Mbs-Standoffs

This document is the property of Mbs-Standoffs Inc. and shall not be reproduced, distributed, or used as a basis for manufacturing without written permission from Mbs-Standoffs Inc.